

## Einspeisklemmen

■ **EK70** Einspeisklemme**Anwendung**

T-Einspeisungen für Fahrdrabt

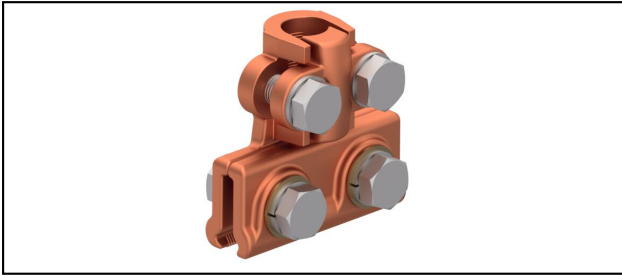

**Eigenschaften**

Anziehdrehmoment 40 Nm

**Material**

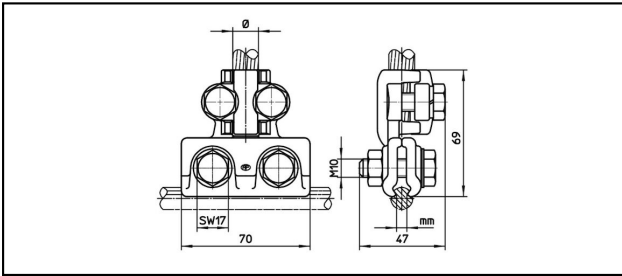
CuNiSi

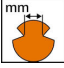
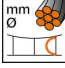
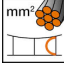

Artikel-Nr.									
635.004.052	3.75 - 8.5	8 - 14	50 - 95						0.576

Technische Spezifikationen: **Einspeisklemme EK70**

Artikel-Nr.	635.004.052
Anziehdrehmoment	40 N·m
Fahrdraht-Kerbe	3.75 - 8.5 mm
Einspeiskabel Durchmesser	8 - 14 mm
Einspeisekabel Fläche	50 - 95 mm <sup>2</sup>
Kommerzielle Spezifikation	
Zolltarifnummer	85359000
Ursprungsland	CH
Logistische Spezifikation	
Kilo / Stück	0.576 kg

