

Gabelendmuffen

■ GI40/40,B20 Gabelendmuffe

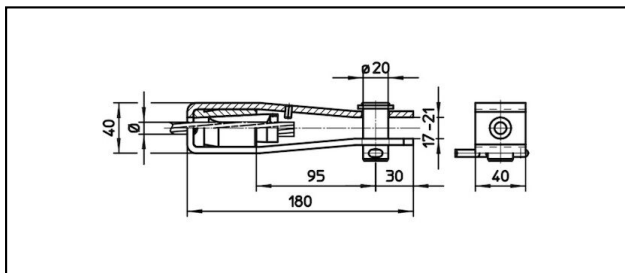

Anwendung

Zugfeste Verbindung für Leiter aus Cu, Bz, Stahl und Staku

Eigenschaften





Bruchlast des Gehäuses min. 60 kN

Material

Gehäuse Stahl rostfrei / Konus AIBz

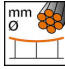
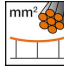
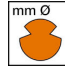
Legende

1) Mit Farbcode

Artikel-Nr.									
610.008.001	S50	9.8	50					0.9	

Technische Spezifikationen: **Gabelendmuffe GI40/40,B20**

Artikel-Nr.	610.008.001
Bahn Produkt Name	S50
Tragseil Durchmesser	9.8 mm
Tragseil Seilfläche	50 mm ²
Kommerzielle Spezifikation	
Zolltarifnummer	85359000
Ursprungsland	CH
Logistische Spezifikation	
Kilo / Stück	0.9 kg

