

Seilhängerklammern

■ SKTF5S

**Anwendung**

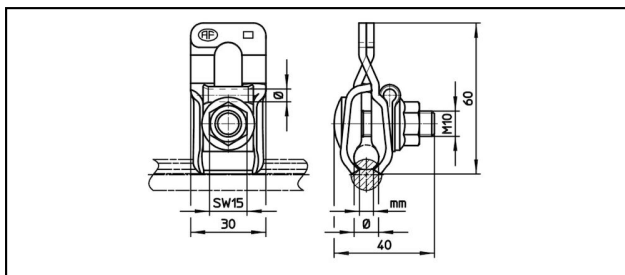

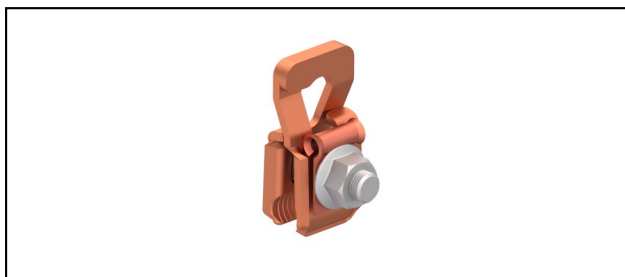



Für Seilhänger, stromführend

Eigenschaften

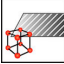
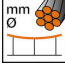
Anziehdrehmoment 20-25 Nm

Material

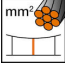
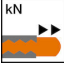
Körper aus CuNiSi oder Stahl rostfrei

Artikel-Nr.									
625.035.000	CuNiSi	9 - 13	50 - 95	5.5 - 7	4.5	10	4		0.115
620.001.000	InoxA2	9 - 13	50 - 95	5.5 - 7	4.5	10	4		0.109

Technische Spezifikationen: **SKTF5S**

	625.035.000	620.001.000
Material	CuNiSi	InoxA2
Tragseil Durchmesser	9 - 13 mm	
Tragseil Seilfläche	50 - 95 mm ²	
Fahrdraht-Kerbe	5.5 - 7 mm	
Hängerseil Durchmesser	4.5 mm	
Hängerseil Fläche	10 mm ²	
Ausreisskraft	4 kN	
Anziehdrehmoment_2	20 - 25 N·m	
Kommerzielle Spezifikation		
Zolltarifnummer	85359000	
Ursprungsland	CH	
Logistische Spezifikation		
Kilo / Stück	0.115 kg	0.109 kg

