

# INSTALLATION INSTRUCTIONS

MESSENGER-WIRE SUPPORT TYPE TS

Edition 2011/10

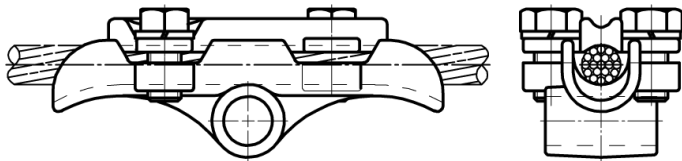

1. Remove screws, lock washers and the terminal cover.
2. Mount the body onto the bolt.
3. Place the conductor onto the body.
4. Put on the terminal cover according to the cross section of the conductor.
5. Mount the screws and lock washers.
6. Tighten the screws with 25 Nm.

## Maintenance and Service

The messenger-wire support is maintenance free, the life-time correlates with the life-time of the conductor.

