

## Messenger wire and contact wire insulators

### ■ TSI017 Catenary insulators

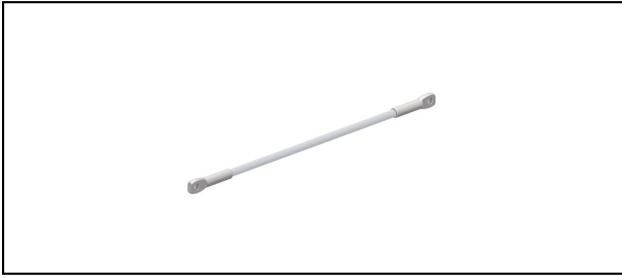

**Application**  
Catenary insulator

**Characteristics**  
SML: 100 kN  
Nominal working tensile load 40 kN

**Material**  
Stainless steel, fiberglass rod PTFE coated

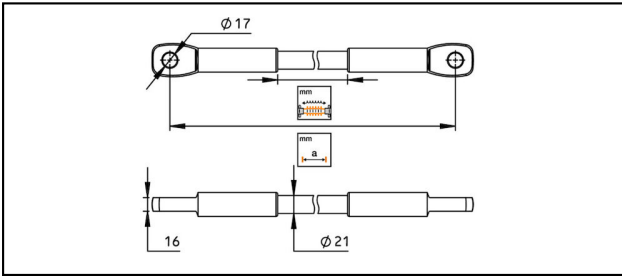

Article-Nr.	mm a	mm a							Kg 1.4
657.027.000	850	600							

Technical Specifications: **Catenary insulators TSI017**

Article No.	657.027.000
<b>Length a</b>	850 mm
<b>Creeping distance</b>	600 mm
<b>Specified mechanical load (SML)</b>	100 kN
Commercial specification	
<b>Customs number</b>	85353000
<b>country of origin</b>	CH
Logistic specification	
<b>Kilo / piece</b>	1.4 kg

