

## Messenger wire and contact wire insulators

### ■ TSIO20.25 Catenary insulators

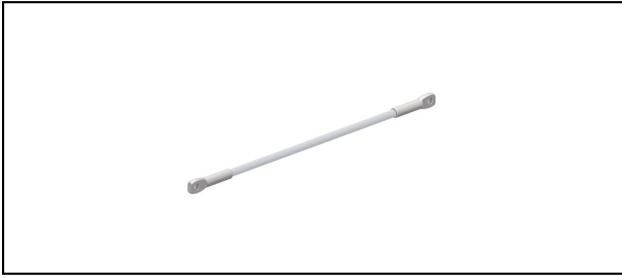

**Application**  
Catenary insulator

**Characteristics**  
SML: 100 kN  
Nominal working tensile load 40 kN

**Material**  
Stainless steel, fiberglass rod PTFE coated

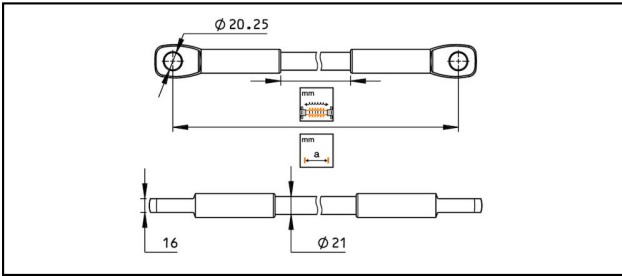

Article-Nr.	mm a	mm a								Kg 
657.010.725	1750	1500								2.1

Technical Specifications: **Catenary insulators TSIO20.25**

Article No.	657.010.725
<b>Length a</b>	1750 mm
<b>Creeping distance</b>	1500 mm
<b>Specified mechanical load (SML)</b>	100 kN
Commercial specification	
<b>Customs number</b>	85353000
<b>country of origin</b>	CH
Logistic specification	
<b>Kilo / piece</b>	2.1 kg

