

Conical coupler

■ KV186 Cone connector

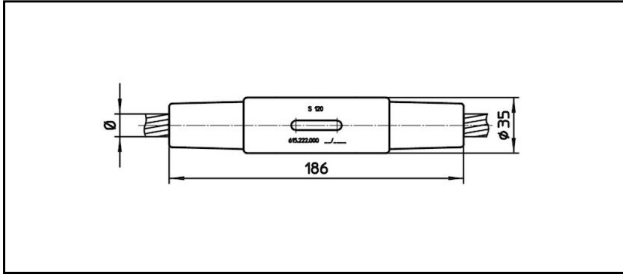

Application

Tension and current-proofed connection for Cu, Bronze, Steel and Cu-Steel cables

Characteristics







Service load min. 3 kN / max. 25 kN
Breaking load of corpus min. 80 kN

Material

Corpus CuNiSi / Collet AIBz resp. stainless steel

Legend

1) Colour code

| Article-Nr. |  |  |  |  |  | | |  |  |
|-------------|---|---|---|---|---|--|--|---|---|
| 615.006.106 | S150 | 15.75 | 150 | | | | | 0.76 | |

Technical Specifications: **Cone connector KV186**

| | |
|-------------------------------|---------------------|
| Article No. | 615.006.106 |
| Rail product name | S150 |
| Catenary wire diameter | 15.75 mm |
| Catenary wire section | 150 mm ² |
| Commercial specification | |
| Customs number | 85359000 |
| country of origin | CH |
| Logistic specification | |
| Kilo / piece | 0.76 kg |

