

## Conical coupler

### ■ KV208 Cone connector

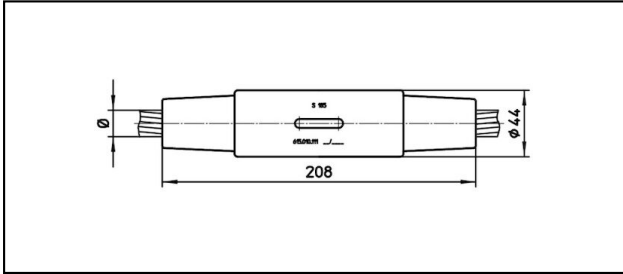

#### Application

Tension and current-proofed connection for Cu, Bronze, Steel and Cu-Steel cables

#### Characteristics







Service load min. 3 kN / max. 25 kN

#### Material

Corpus CuNiSi / Collet AIBz

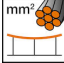
#### Legend

1) Colour code

Article-Nr.									
615.239.020	S126	14.5	126	100				1.68	

Technical Specifications: **Cone connector KV208**

Article No.	615.239.020
<b>Rail product name</b>	S126
<b>Catenary wire diameter</b>	14.5 mm
<b>Catenary wire section</b>	126 mm <sup>2</sup>
<b>Minimum breaking load</b>	100
Commercial specification	
<b>Customs number</b>	85359000
<b>country of origin</b>	CH
Logistic specification	
<b>Kilo / piece</b>	1.68 kg

