

## Conical coupler

### ■ RV166 Conical coupling

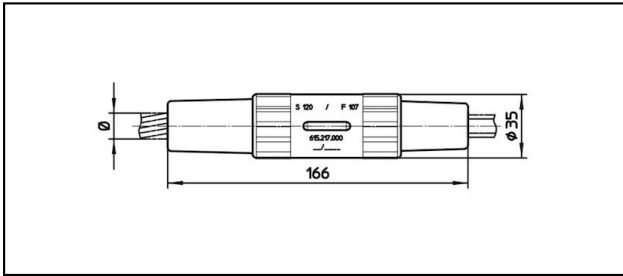

#### Application

Tensioned and current-proofed Cu, Cu-Steel or Bz cables

#### Characteristics

Service load min. 3 kN / max. 25 kN







Breaking load of corpus min. 80 kN

#### Material

Corpus CuNiSi / Collet AIBz

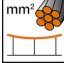
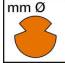
#### Legend

1) Colour code

Article-Nr.									
615.217.000	S120/F107	14.5	120	12.75	107			0.75	1

Technical Specifications: **Conical coupling RV166**

Article No.	615.217.000
<b>Rail product name</b>	S120/F107
<b>Catenary wire diameter</b>	14.5 mm
<b>Catenary wire section</b>	120 mm <sup>2</sup>
<b>Contact wire diameter</b>	12.75 mm
<b>Contact wire section</b>	107 mm <sup>2</sup>
<b>comment</b>	1
Commercial specification	
<b>Customs number</b>	85359000
<b>country of origin</b>	CH
Texte	
<b>comment</b>	1
Logistic specification	
<b>Kilo / piece</b>	0.75 kg

