

Conical coupler

KV156

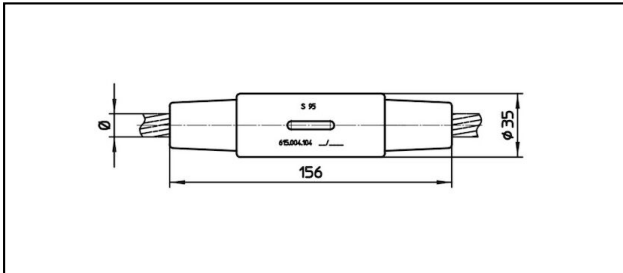

Application

Tension and current-proofed connection for Cu, Bronze, Steel and Cu-Steel cables

Characteristics

Service load min. 3 kN / max. 25 kN

Breaking load of corpus min. 80 kN

Material

Corpus CuNiSi / Collet AIBz resp. stainless steel

Legend

- 1) Sealed
- 2) Collet stainless steel
- 3) Colour code

Article-Nr.	«N»	mm Ø	mm²	mm Ø	mm²			Kg	
615.002.102	S50	8.9	50					0.72	
615.003.103	S70	10.75	70					0.71	
615.008.150	S85/D11.5	11.25	85	11.5	104			0.7	
615.004.104	S95	12.75	95					0.7	
615.021.000	D8	7.9	8					0.69	1
615.012.102	S48	8.9	48					0.69	1
615.016.103	S72			9.6	72			0.71	1
615.205.000	S65	10.75	65					0.69	1
615.015.100	S104			11.25	104			0.69	1
615.014.104	S95	12.75	95					0.7	1
615.022.000	S93.3	12.75	93.3					0.7	2
615.221.000	S24	6.9	24					0.69	3
615.219.000	S70	10.75	70					0.69	3
615.231.000	S53.5	9.4	53.5					0.7	
615.234.500	AWG4/0 FD107			12.4	107				

Technical Specifications: **KV156**

	615.002.102	615.003.103	615.008.150	615.004.104
Rail product name	S50	S70	S85/D11.5	S95
Catenary wire diameter	8.9 mm	10.75 mm	11.25 mm	12.75 mm
Catenary wire section	50 mm ²	70 mm ²	85 mm ²	95 mm ²
Contact wire diameter			11.5 mm	
Contact wire section			104 mm ²	
Commercial specification				
Customs number	85359000			
country of origin	CH			
Logistic specification				
Kilo / piece	0.72 kg	0.71 kg	0.7 kg	

	615.021.000	615.012.102	615.016.103	615.205.000
Rail product name	D8	S48	S72	S65
Catenary wire diameter	7.9 mm	8.9 mm		10.75 mm
Catenary wire section	8 mm ²	48 mm ²		65 mm ²
Contact wire diameter			9.6 mm	
Contact wire section			72 mm ²	
Commercial specification				
Customs number	0	85359000		
country of origin	undefined	CH		
Logistic specification				
Kilo / piece	0.69 kg		0.71 kg	0.69 kg

	615.015.100	615.014.104	615.022.000	615.221.000
Rail product name	S104	S95	S93.3	S24
Catenary wire diameter		12.75 mm		6.9 mm
Catenary wire section		95 mm ²	93.3 mm ²	24 mm ²
Contact wire diameter	11.25 mm			
Contact wire section	104 mm ²			
Commercial specification				
Customs number	85359000			
country of origin	CH			
Logistic specification				
Kilo / piece	0.69 kg	0.7 kg		0.69 kg

	615.219.000	615.231.000	615.234.500	
Rail product name	S70	S53.5	AWG4/0 FD107	
Catenary wire diameter	10.75 mm	9.4 mm		
Catenary wire section	70 mm ²	53.5 mm ²		
Contact wire diameter			12.4 mm	
Contact wire section			107 mm ²	
Commercial specification				
Customs number	85359000			
country of origin	CH			
Logistic specification				
Kilo / piece	0.69 kg	0.7 kg		

