

Conical coupler

RV166

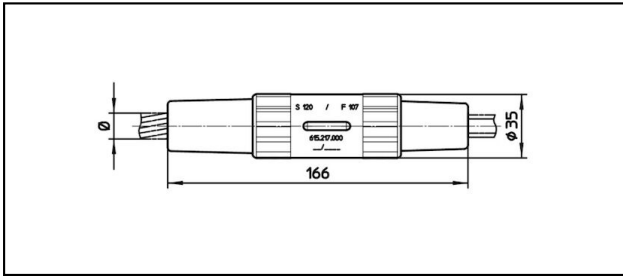

Application

Tensioned and current-proofed Cu, Cu-Steel or Bz cables

Characteristics

Service load min. 3 kN / max. 25 kN

Breaking load of corpus min. 80 kN

Material

Corpus CuNiSi / Collet AIBz

Legend

1) Colour code

Article-Nr.									
615.217.000	S120/F107	14.5	120	12.75	107			0.75	1

Technical Specifications: **RV166**

	615.217.000
Rail product name	S120/F107
Catenary wire diameter	14.5 mm
Catenary wire section	120 mm ²
Contact wire diameter	12.75 mm
Contact wire section	107 mm ²
Commercial specification	
Customs number	85359000
country of origin	CH
Logistic specification	
Kilo / piece	0.75 kg

