

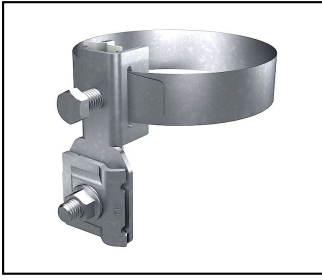



## Conductor connections and junctions

### ■ AV 26 Contact clip

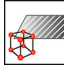
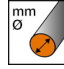
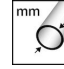

#### Characteristics

With connection terminal for longitudinal and transversal wiring.  
Not to be used in the ground.

| Article-Nr. | E-Number    |  |  |  |  |  |  |  |  |  |
|-------------|-------------|---|---|---|---|--|--|--|--|---|
| 280.105.004 | 156 831 090 | H   | InoxA2  | 6 - 10  | 20 - 180  |  |  |  |  | 10  |

Technical Specifications: **Contact clip AV 26**

|   |                         |
|---|-------------------------|
| Article No.                                       | 280.105.004             |
| <b>Approved class H / N (EN 62561-1)</b>          | H                       |
| <b>Material</b>                                   | InoxA2                  |
| <b>Wire diameter</b>                              | 6 - 10 mm               |
| <b>External diameter</b>                          | 20 - 180 mm             |
| <b>Cross section of the connecting conductors</b> | 25 - 50 mm <sup>2</sup> |
| <b>Clamping/chucking range</b>                    | 20 - 180 mm             |
| <b>Number of conductors</b>                       | 1                       |
| <b>Surface protection</b>                         | unbehandelt             |
| <b>required torque</b>                            | 15 N·m                  |
| Commercial specification                          |                         |
| <b>Customs number</b>                             | 85389000                |
| <b>country of origin</b>                          | CE*                     |
| Logistic specification                            |                         |
| <b>VPE Weight</b>                                 | 1.74 kg                 |

