

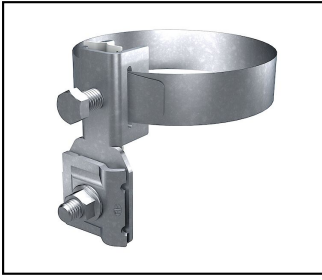



## Conductor connections and junctions

### ■ AV 26 Contact clip

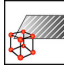
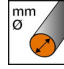
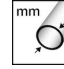

#### Characteristics

With connection terminal for longitudinal and transversal wiring.  
Not to be used in the ground.

Article-Nr.	E-Number									
280.105.005	156 832 370	H	InoxA2	6 - 10	20 - 250					10

Technical Specifications: **Contact clip AV 26**

Article No.	280.105.005
<b>Approved class H / N (EN 62561-1)</b>	H
<b>Material</b>	InoxA2
<b>Wire diameter</b>	6 - 10 mm
<b>External diameter</b>	20 - 250 mm
<b>Cross section of the connecting conductors</b>	25 - 50 mm <sup>2</sup>
<b>Clamping/chucking range</b>	20 - 250 mm
<b>Number of conductors</b>	1
<b>Surface protection</b>	unbehandelt
<b>required torque</b>	15 N·m
Commercial specification	
<b>Customs number</b>	85389000
<b>country of origin</b>	CE*
Logistic specification	
<b>VPE Weight</b>	1.95 kg