

Splice fittings

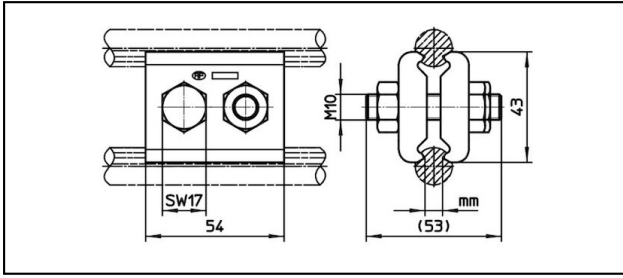

■ **SK2-54**



Application
Parallel clamp for contact wires

Characteristics
Torque 50 Nm
Not for full tension

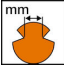
Material
Clamping plates CuNiSi

Article-Nr.									
635.157.000	4.5 - 8.5								0.445

Technical Specifications: **SK2-54**

	635.157.000
Starting torque	50 N·m
Contact wire groove	4.5 - 8.5 mm
Commercial specification	
Customs number	85359000
country of origin	CH
Logistic specification	
Kilo / piece	0.445 kg

