

### Splice fittings

■ **SK1-23**

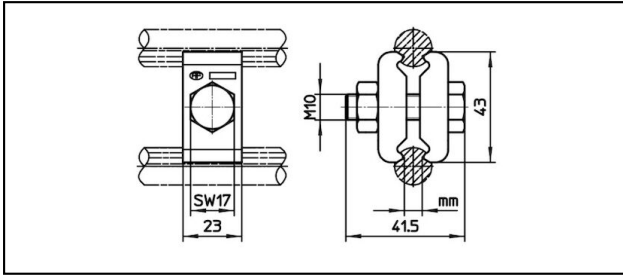

**Application**  
Parallel clamp for contact wires

**Characteristics**  
Torque 50 Nm  
Not for full tension

**Material**  
Clamping plates CuNiSi

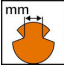
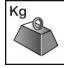
Article-Nr.									
635.165.000	4.5 - 8.5								0.25

Technical Specifications: **SK1-23**

	635.165.000
<b>Contact wire groove</b>	4.5 - 8.5 mm
<b>Starting torque</b>	50 N·m
Commercial specification	
<b>Customs number</b>	85359000
<b>country of origin</b>	CH
Logistic specification	
<b>Kilo / piece</b>	0.25 kg

