

Splice fittings

■ **SK4-95** Splice fitting

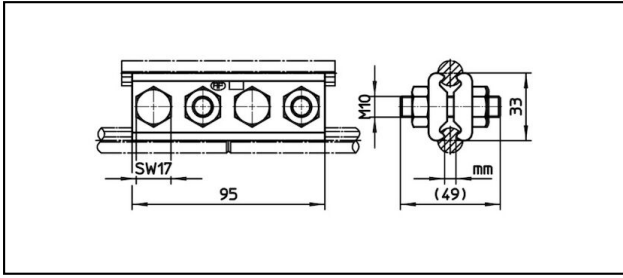

Application



Contact wire splice fitting for copper contact wire

Characteristics

Torque 50 Nm

Material

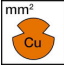
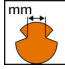
Clamping plates CuNiSi

Article-Nr.	 mm²	 mm							 Kg
635.016.000	- 107	4.5 - 8.5							0.5

Technical Specifications: **Splice fitting SK4-95**

Article No.	635.016.000
Starting torque	50 N·m
Contact wire section Cu	- 107 mm ²
Contact wire groove	4.5 - 8.5 mm
Commercial specification	
Customs number	85359000
country of origin	CH
Logistic specification	
Kilo / piece	0.5 kg

