

Rail clamps

■ DS206 Diagonal rail clamp

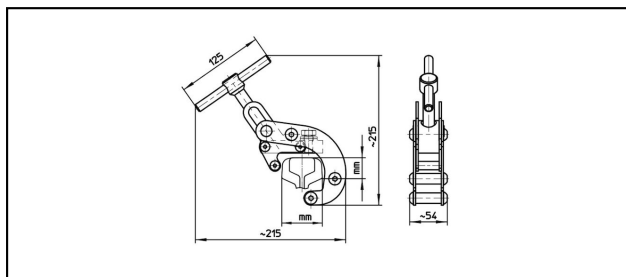

Application

Adjustable to rails UIC 54E to UIC 60



Characteristics

Earthing connection bolt M12

Connection bolt M12

Material

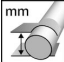
Clamp stainless steel. Contact CuNiSi

Article-Nr.	 mm	 kA/ms I _k							 Kg
640.080.000	65 - 85	40/300							1.4

Technical Specifications: **Diagonal rail clamp DS206**

Article No.	640.080.000
Clamping range	65 - 85 mm
Short circuit current	40/300
Commercial specification	
Customs number	85359000
country of origin	CH
Logistic specification	
Kilo / piece	1.4 kg

