

## Rail clamps

### ■ DS206 Diagonal rail clamp

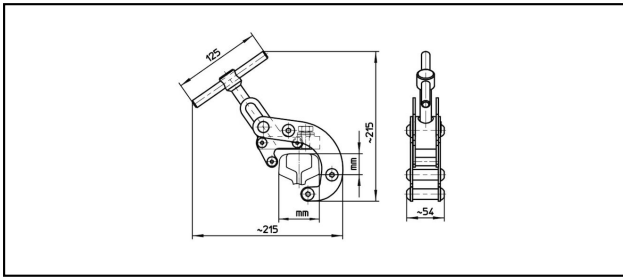

#### Application

Adjustable to rails UIC 54E to UIC 60



#### Characteristics

Earthing connection bolt M12

Connection bolt M12

#### Material

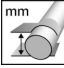
Clamp stainless steel. Contact CuNiSi

Article-Nr.	 mm	 kA/ms I <sub>k</sub>							 Kg
640.080.000	65 - 85	40/300							1.4

Technical Specifications: **Diagonal rail clamp DS206**

	640.080.000
<b>Clamping range</b>	65 - 85 mm
<b>Short circuit current</b>	40/300 kA/ms
Commercial specification	
<b>Customs number</b>	85359000
<b>country of origin</b>	CH
Logistic specification	
<b>Kilo / piece</b>	1.4 kg

