

### Various clamps

■ **FK3-153** Fixpoint clamp

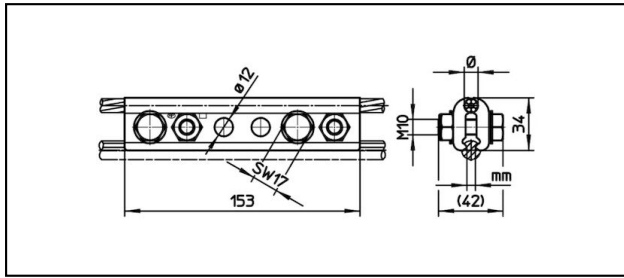

**Application**





For copper or copper alloy contact wire and fix point wire

**Characteristics**

Torque 50 Nm  
6 holes / 4 screws

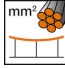
**Material**

Clamping plates CuNiSi

Article-Nr.									
635.109.102	9	50	5.6	70 - 150				0.783	1

Technical Specifications: **Fixpoint clamp FK3-153**

	635.109.102
<b>Starting torque</b>	50 N·m
<b>Catenary wire diameter</b>	9 mm
<b>Catenary wire section</b>	50 mm <sup>2</sup>
<b>Contact wire groove</b>	5.6 mm
<b>Contact wire section</b>	70 - 150 mm <sup>2</sup>
Commercial specification	
<b>Customs number</b>	85359000
<b>country of origin</b>	CH
Logistic specification	
<b>Kilo / piece</b>	0.783 kg

