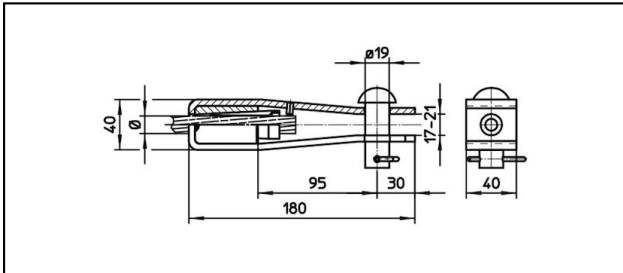

Forked collar sockets

■ GI40/40,B19 Spc.

**Application**

For tensioned Cu, Cu-Steel, Steel or Bz cables

Characteristics

Service load min. 3 kN / max. 25 kN

Breaking load of corpus min. 60 kN

Material

Corpus stainless steel / Collet AlBz / Bolt galvanized steel

Article-Nr.	«N»	mm Ø	mm²	mm Ø	mm²				Kg
610.094.000	S50	9.8	50						0.91
610.085.000	S70	10.8	70						0.91
610.095.000	S95	12.9	95						0.91
610.096.000	S120	14	120						0.91
610.093.000	FD100			12.4	100				0.91
610.084.000	FD120			13.8	120				0.91

Technical Specifications: **GI40/40,B19 Spc.**

	610.094.000	610.085.000	610.095.000	610.096.000
Rail product name	S50	S70	S95	S120
Catenary wire diameter	9.8 mm	10.8 mm	12.9 mm	14 mm
Catenary wire section	50 mm ²	70 mm ²	95 mm ²	120 mm ²
Contact wire diameter				
Contact wire section				
Commercial specification				
Customs number	85359000		0	85359000
country of origin	CH		undefined	CH
Logistic specification				
Kilo / piece	0.91 kg			

	610.093.000	610.084.000
Rail product name	FD100	FD120
Catenary wire diameter		
Catenary wire section		
Contact wire diameter	12.4 mm	13.8 mm
Contact wire section	100 mm ²	120 mm ²
Commercial specification		
Customs number	85359000	
country of origin	CH	
Logistic specification		
Kilo / piece	0.91 kg	

