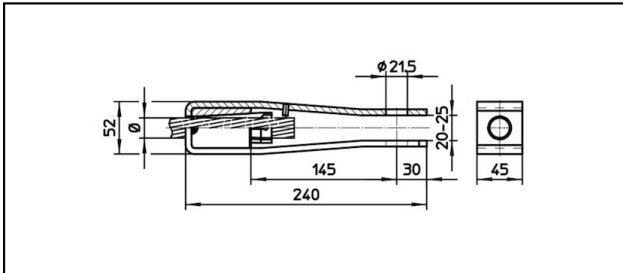

Forked collar sockets

■ GI52/45,21.5

**Application**

Tensioned Cu, Cu-Steel, steel or Bz cables

Characteristics





Service load min. 3 kN / max. 25 kN

Breaking load of corpus min. 120 kN

Collet of stainless steel for steel cables

Material

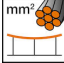
Corpus stainless steel / Collet AlBz resp. stainless steel

Article-Nr.									
610.086.000	S160 St	16.8	160						1.512

Technical Specifications: **GI52/45,21.5**

	610.086.000
Rail product name	S160 St
Catenary wire diameter	16.8 mm
Catenary wire section	160 mm ²
Commercial specification	
Customs number	85359000
country of origin	CH
Logistic specification	
Kilo / piece	1.512 kg

