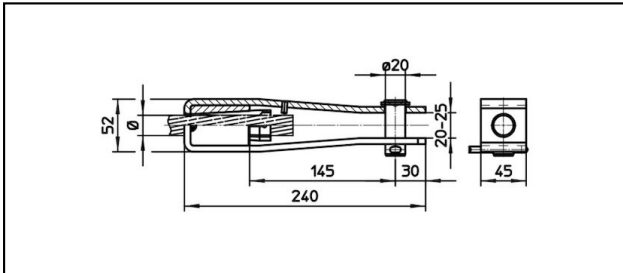

## Forked collar sockets

## ■ G152/45,B20

**Application**

Tensioned Cu, Cu-Steel, steel or Bz cables

**Characteristics**

Service load min. 3 kN / max. 25 kN







Breaking load of corpus min. 120 kN

**Material**

Corpus stainless steel / Collet AlBz resp. stainless steel

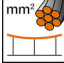
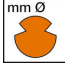
**Legend**

1) Collet of stainless steel for steel cables

Article-Nr.									
610.067.000	S101	15.5	101					1.67	1
610.000.010	S144	15.8	144					1.66	
610.081.000	S240	21	240					1.66	
610.102.000	S135 St	15.5	135					1.67	1
610.105.000	FD150			14.5	150			1.66	

Technical Specifications: **GI52/45,B20**

	610.067.000	610.000.010	610.081.000	610.102.000
<b>Rail product name</b>	S101	S144	S240	S135 St
<b>Catenary wire diameter</b>	15.5 mm	15.8 mm	21 mm	15.5 mm
<b>Catenary wire section</b>	101 mm <sup>2</sup>	144 mm <sup>2</sup>	240 mm <sup>2</sup>	135 mm <sup>2</sup>
<b>Contact wire diameter</b>				
<b>Contact wire section</b>				
Commercial specification				
<b>Customs number</b>	85359000			
<b>country of origin</b>	CH			undefined
Logistic specification				
<b>Kilo / piece</b>	1.67 kg	1.66 kg	1.67 kg	1.67 kg

	610.105.000
<b>Rail product name</b>	FD150
<b>Catenary wire diameter</b>	
<b>Catenary wire section</b>	
<b>Contact wire diameter</b>	14.5 mm
<b>Contact wire section</b>	150 mm <sup>2</sup>
Commercial specification	
<b>Customs number</b>	0
<b>country of origin</b>	undefined
Logistic specification	
<b>Kilo / piece</b>	1.66 kg

