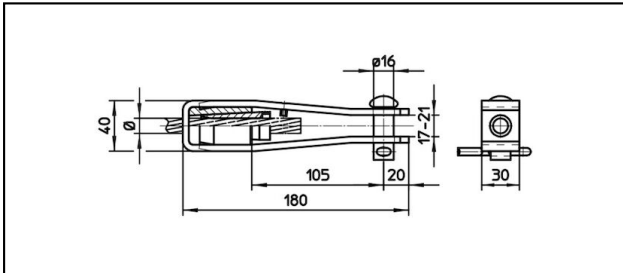

Forked collar sockets

■ **G140/30,B16** Forked collar socket**Application**

Cu, Cu-steel, Steel or Bz tensioned cables

Characteristics

Service load min. 3 kN / max. 25 kN

Breaking load of corpus min. 60 kN







Material

Corpus stainless steel / Collet AlBz resp. stainless steel

Legend

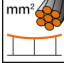
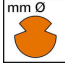
1) Collet of stainless steel for steel cables

2) With colour code

Article-Nr.									
610.058.000	S40 St	8.5	40					0.82	1

Technical Specifications: **Forked collar socket GI40/30,B16**

Article No.	610.058.000
Rail product name	S40 St
Catenary wire diameter	8.5 mm
Catenary wire section	40 mm ²
comment	1
Commercial specification	
Customs number	85359000
country of origin	CH
Texte	
comment	1
Logistic specification	
Kilo / piece	0.82 kg

