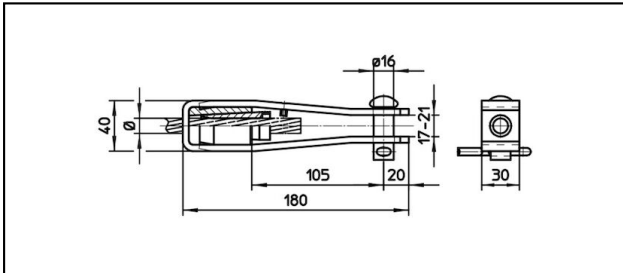

## Forked collar sockets

■ **G140/30,B16** Forked collar socket**Application**

Cu, Cu-steel, Steel or Bz tensioned cables

**Characteristics**

Service load min. 3 kN / max. 25 kN

Breaking load of corpus min. 60 kN







**Material**

Corpus stainless steel / Collet AlBz resp. stainless steel

**Legend**

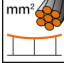
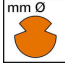
1) Collet of stainless steel for steel cables

2) With colour code

| Article-Nr. |  |  |  |  |  |  |  |  |  |
|-------------|---|---|---|---|---|--|--|---|---|
| 610.027.102 | S50 St  | 9.6   | 50  |   |   |  |  | 0.82  | 1   |

Technical Specifications: Forked collar socket GI40/30,B16

|                          |                    |
|--------------------------|--------------------|
| Article No.              | 610.027.102        |
| Rail product name        | S50 St             |
| Catenary wire diameter   | 9.6 mm             |
| Catenary wire section    | 50 mm <sup>2</sup> |
| comment                  | 1                  |
| Commercial specification |                    |
| Customs number           | 85359000           |
| country of origin        | CH                 |
| Texte                    |                    |
| comment                  | 1                  |
| Logistic specification   |                    |
| Kilo / piece             | 0.82 kg            |

