

## Forked collar sockets

### ■ GI40/40,B19 Spc. Forked collar socket

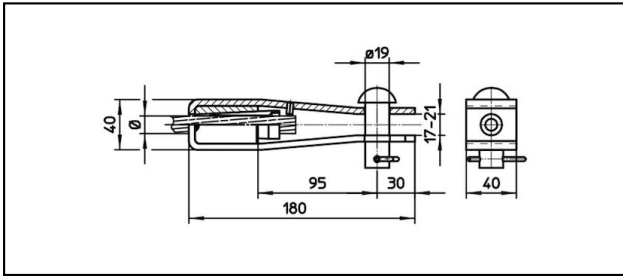

#### Application

For tensioned Cu, Cu-Steel, Steel or Bz cables





#### Characteristics

Service load min. 3 kN / max. 25 kN

Breaking load of corpus min. 60 kN

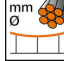
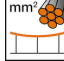
#### Material

Corpus stainless steel / Collet AlBz / Bolt galvanized steel

Article-Nr.									
610.094.000	S50	9.8	50						0.91

Technical Specifications: **Forked collar socket GI40/40,B19 Spc.**

Article No.	610.094.000
<b>Rail product name</b>	S50
<b>Catenary wire diameter</b>	9.8 mm
<b>Catenary wire section</b>	50 mm <sup>2</sup>
Commercial specification	
<b>Customs number</b>	85359000
<b>country of origin</b>	CH
Logistic specification	
<b>Kilo / piece</b>	0.91 kg

