

Forked collar sockets

■ GI40/40,21.5 Forked collar socket

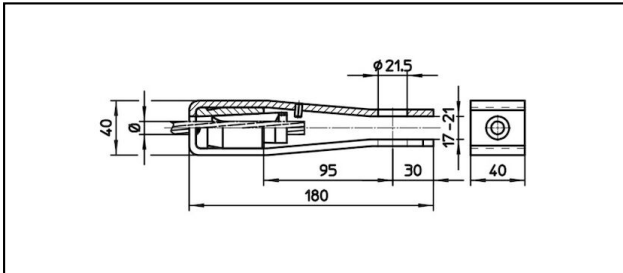

Application

Cu, Cu-steel, steel or Bz tensioned cables

Characteristics

Service load min. 3 kN / max. 25 kN

Breaking load of corpus min. 60 kN







Material

Corpus stainless steel / Collet AlBz resp. stainless steel

Legend

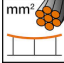
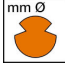
1) Collet of stainless steel for steel cables

2) With colour code

Article-Nr.									
610.060.000	S120	14	120					0.75	

Technical Specifications: **Forked collar socket GI40/40,21.5**

Article No.	610.060.000
Rail product name	S120
Catenary wire diameter	14 mm
Catenary wire section	120 mm ²
Commercial specification	
Customs number	85359000
country of origin	CH
Logistic specification	
Kilo / piece	0.75 kg

