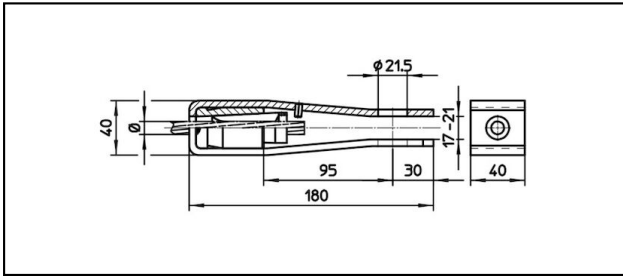

Forked collar sockets

■ **GI40/40,21.5** Forked collar sockets**Application**

Cu, Cu-steel, steel or Bz tensioned cables

Characteristics

Service load min. 3 kN / max. 25 kN

Breaking load of corpus min. 60 kN







Material

Corpus stainless steel / Collet AlBz resp. stainless steel

Legend

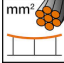
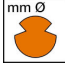
1) Collet of stainless steel for steel cables

2) With colour code

Article-Nr.									
610.057.000	S50 St	9.6	50					0.75	1

Technical Specifications: Forked collar sockets GI40/40,21.5

Article No.	610.057.000
Rail product name	S50 St
Catenary wire diameter	9.6 mm
Catenary wire section	50 mm ²
comment	1
Commercial specification	
Customs number	85359000
country of origin	CH
Texte	
comment	1
Logistic specification	
Kilo / piece	0.75 kg

