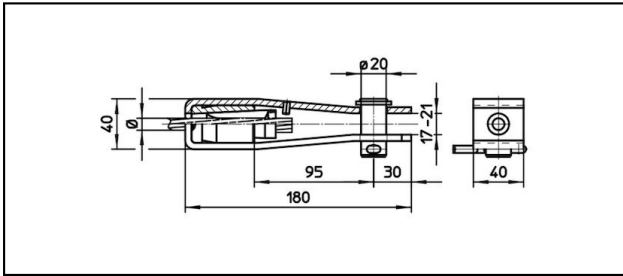

## Forked collar sockets

■ **GI40/40,B20** Forked collar socket**Application**

Cu, Cu-steel, steel or Bz tensioned cables

**Characteristics**

Breaking load of corpus min. 60 kN

**Material**

Corpus stainless steel / Collet AlBz

**Legend**

1) With colour code

| Article-Nr. |     |     |    |  |  |  |  |     |   |
|-------------|-----|-----|----|--|--|--|--|-----|---|
| 610.077.001 | S24 | 6.3 | 24 |  |  |  |  | 0.9 | 1 |

Technical Specifications: Forked collar socket GI40/40,B20

|                          |                    |
|--------------------------|--------------------|
| Article No.              | 610.077.001        |
| Rail product name        | S24                |
| Catenary wire diameter   | 6.3 mm             |
| Catenary wire section    | 24 mm <sup>2</sup> |
| comment                  | 1                  |
| Commercial specification |                    |
| Customs number           | 85359000           |
| country of origin        | CH                 |
| Texte                    |                    |
| comment                  | 1                  |
| Logistic specification   |                    |
| Kilo / piece             | 0.9 kg             |

