

## Forked collar sockets

### ■ GI40/40,B20 Forked collar socket

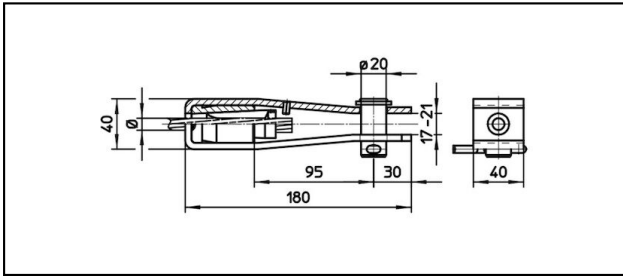

#### Application

Cu, Cu-steel, steel or Bz tensioned cables

#### Characteristics







Breaking load of corpus min. 60 kN

#### Material

Corpus stainless steel / Collet AlBz

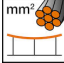
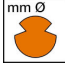
#### Legend

1) With colour code

Article-Nr.									
610.008.001	S50	9.8	50					0.9	

Technical Specifications: **Forked collar socket GI40/40,B20**

Article No.	610.008.001
<b>Rail product name</b>	S50
<b>Catenary wire diameter</b>	9.8 mm
<b>Catenary wire section</b>	50 mm <sup>2</sup>
Commercial specification	
<b>Customs number</b>	85359000
<b>country of origin</b>	CH
Logistic specification	
<b>Kilo / piece</b>	0.9 kg

