

Forked collar sockets

■ GI50/40,B16 Forked collar socket

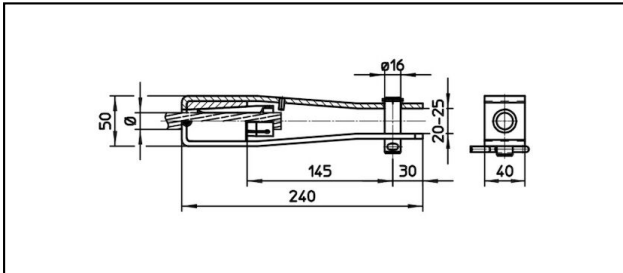

Application

Tensioned Cu, Cu-Steel, steel or Bz cables

Characteristics

Service load min. 3 kN / max. 25 kN

Breaking load of corpus min. 80 kN







Material

Corpus stainless steel / Collet AlBz resp. stainless steel

Legend

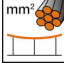
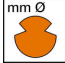
1) Collet of stainless steel for steel cables

2) All components stainless steel A4

Article-Nr.									
610.025.175	FD193/S160	16.8	160	16.8	193			1.51	

Technical Specifications: **Forked collar socket GI50/40,B16**

Article No.	610.025.175
Rail product name	FD193/S160
Catenary wire diameter	16.8 mm
Catenary wire section	160 mm ²
Contact wire diameter	16.8 mm
Contact wire section	193 mm ²
Commercial specification	
Customs number	85359000
country of origin	CH
Logistic specification	
Kilo / piece	1.51 kg

