

Forked collar sockets

■ GI50/40,B16 Forked collar socket

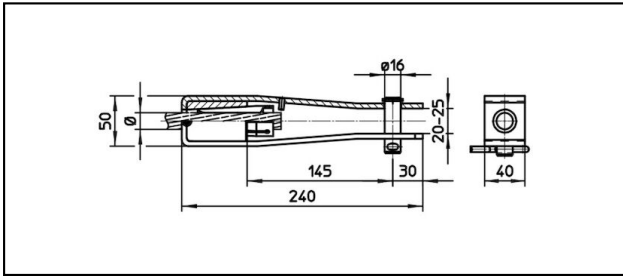

Application

Tensioned Cu, Cu-Steel, steel or Bz cables

Characteristics

Service load min. 3 kN / max. 25 kN

Breaking load of corpus min. 80 kN







Material

Corpus stainless steel / Collet AlBz resp. stainless steel

Legend

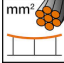
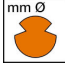
1) Collet of stainless steel for steel cables

2) All components stainless steel A4

Article-Nr.									
610.026.111	S185	17.5	185					1.51	

Technical Specifications: **Forked collar socket GI50/40,B16**

Article No.	610.026.111
Rail product name	S185
Catenary wire diameter	17.5 mm
Catenary wire section	185 mm ²
Commercial specification	
Customs number	85359000
country of origin	CH
Logistic specification	
Kilo / piece	1.51 kg

