

Forked collar sockets

■ GI50/40,B16 Forked collar socket

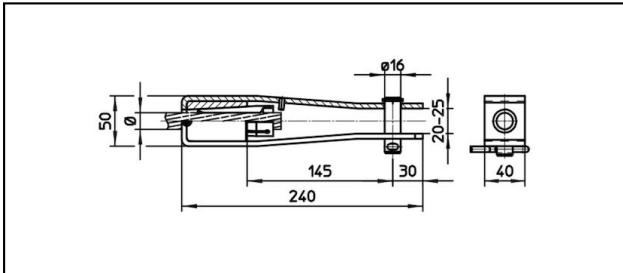

Application

Tensioned Cu, Cu-Steel, steel or Bz cables

Characteristics

Service load min. 3 kN / max. 25 kN

Breaking load of corpus min. 80 kN







Material

Corpus stainless steel / Collet AlBz resp. stainless steel

Legend

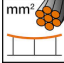
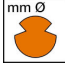
1) Collet of stainless steel for steel cables

2) All components stainless steel A4

Article-Nr.									
610.059.000	S101 St	15.5	101					1.51	1

Technical Specifications: **Forked collar socket GI50/40,B16**

Article No.	610.059.000
Rail product name	S101 St
Catenary wire diameter	15.5 mm
Catenary wire section	101 mm ²
comment	1
Commercial specification	
Customs number	85359000
country of origin	CH
Texte	
comment	1
Logistic specification	
Kilo / piece	1.51 kg

