

Forked collar sockets

■ GI50/40,B16 Forked collar socket

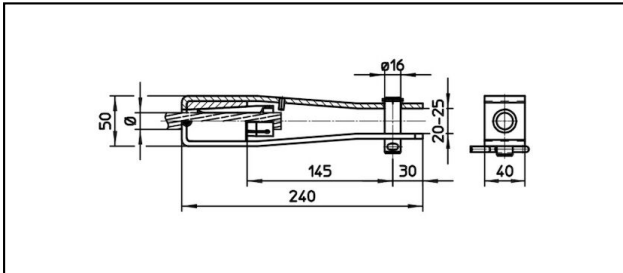

Application

Tensioned Cu, Cu-Steel, steel or Bz cables

Characteristics

Service load min. 3 kN / max. 25 kN

Breaking load of corpus min. 80 kN







Material

Corpus stainless steel / Collet AlBz resp. stainless steel

Legend

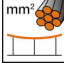
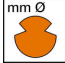
1) Collet of stainless steel for steel cables

2) All components stainless steel A4

| Article-Nr. |  |  |  |  |  | | |  |  |
|-------------|---|---|---|---|---|--|--|---|---|
| 610.000.006 | FD150 | | | 15 | 150 | | | 1.51 | |

Technical Specifications: **Forked collar socket GI50/40,B16**

| | |
|------------------------------|---------------------|
| Article No. | 610.000.006 |
| Rail product name | FD150 |
| Contact wire diameter | 15 mm |
| Contact wire section | 150 mm ² |
| Commercial specification | |
| Customs number | 85359000 |
| country of origin | CH |
| Logistic specification | |
| Kilo / piece | 1.51 kg |

