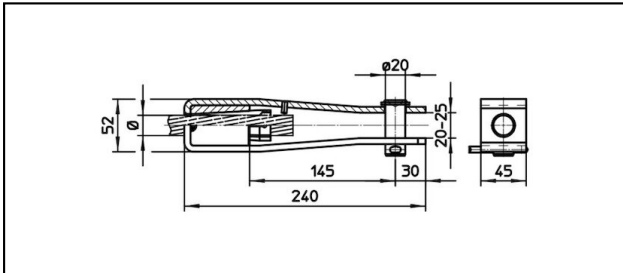

## Forked collar sockets

■ **G152/45,B20** Forked collar socket**Application**

Tensioned Cu, Cu-Steel, steel or Bz cables

**Characteristics**

Service load min. 3 kN / max. 25 kN







Breaking load of corpus min. 120 kN

**Material**

Corpus stainless steel / Collet AlBz resp. stainless steel

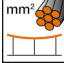
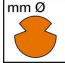
**Legend**

1) Collet of stainless steel for steel cables

Article-Nr.									
610.000.010	S144	15.8	144					1.66	

Technical Specifications: **Forked collar socket GI52/45,B20**

Article No.	610.000.010
<b>Rail product name</b>	S144
<b>Catenary wire diameter</b>	15.8 mm
<b>Catenary wire section</b>	144 mm <sup>2</sup>
Commercial specification	
<b>Customs number</b>	85359000
<b>country of origin</b>	CH
Logistic specification	
<b>Kilo / piece</b>	1.66 kg

