

## Forked collar sockets

### ■ GI52/45,B20 Forked collar socket

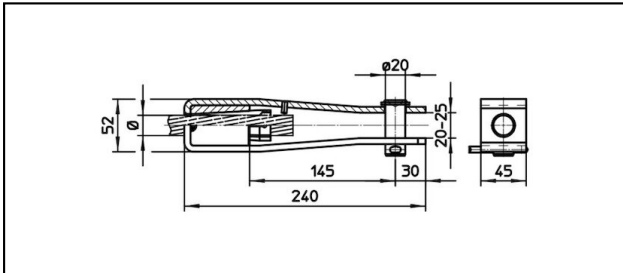

#### Application

Tensioned Cu, Cu-Steel, steel or Bz cables

#### Characteristics

Service load min. 3 kN / max. 25 kN







Breaking load of corpus min. 120 kN

#### Material

Corpus stainless steel / Collet AlBz resp. stainless steel

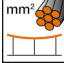
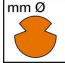
#### Legend

1) Collet of stainless steel for steel cables

Article-Nr.									
610.081.000	S240	21	240					1.66	

Technical Specifications: **Forked collar socket GI52/45,B20**

Article No.	610.081.000
<b>Rail product name</b>	S240
<b>Catenary wire diameter</b>	21 mm
<b>Catenary wire section</b>	240 mm <sup>2</sup>
Commercial specification	
<b>Customs number</b>	85359000
<b>country of origin</b>	CH
Logistic specification	
<b>Kilo / piece</b>	1.66 kg

