

## Forked collar sockets

### ■ GI52/45,B20 Forked collar socket

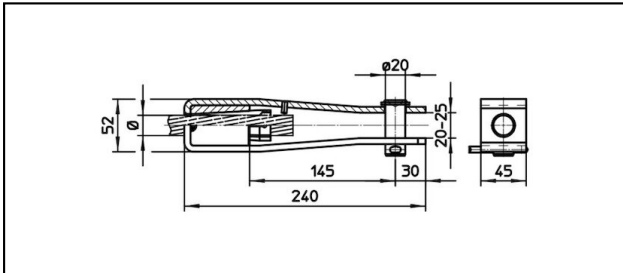

#### Application

Tensioned Cu, Cu-Steel, steel or Bz cables

#### Characteristics

Service load min. 3 kN / max. 25 kN







Breaking load of corpus min. 120 kN

#### Material

Corpus stainless steel / Collet AlBz resp. stainless steel

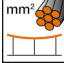
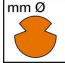
#### Legend

1) Collet of stainless steel for steel cables

Article-Nr.									
610.105.000	FD150			14.5	150			1.66	

Technical Specifications: **Forked collar socket GI52/45,B20**

Article No.	610.105.000
<b>Rail product name</b>	FD150
<b>Contact wire diameter</b>	14.5 mm
<b>Contact wire section</b>	150 mm <sup>2</sup>
Commercial specification	
<b>Customs number</b>	0
<b>country of origin</b>	undefined
Logistic specification	
<b>Kilo / piece</b>	1.66 kg

