

Various clamps

■ **EB** Ground cable support

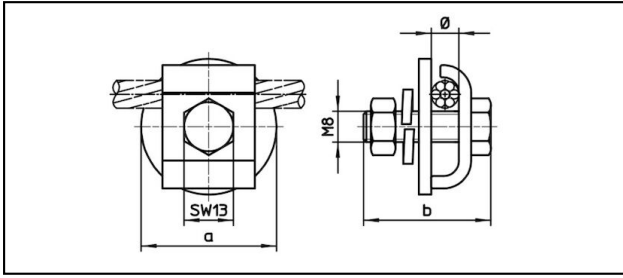





Application
For earthing wire

Characteristics
Bolt M8 SW13
Torque 25 Nm

Material
Clamping plates CuNiSi

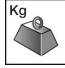
Legend
1) M10 / SW 17
2) Without hexagon nut and MS snap ring

Article-Nr.									
635.099.040	4	35	40.5					0.04	2

Technical Specifications: **Ground cable support EB**

Article No.	635.099.040
Length a	35 mm
Width b	40.5 mm
Catenary wire diameter	4 mm
Starting torque	25 N·m
comment	2
Commercial specification	
Customs number	0
country of origin	undefined
Texte	
comment	2
Logistic specification	
Kilo / piece	0.04 kg

