

Various clamps

■ **EB** Ground cable support

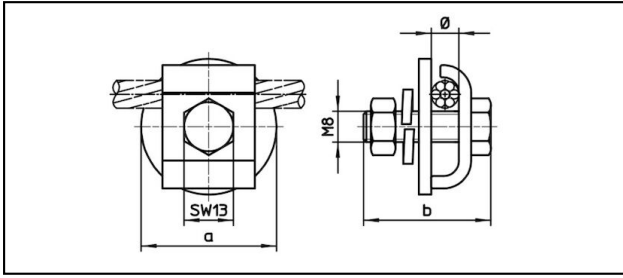





Application
For earthing wire

Characteristics
Bolt M8 SW13
Torque 25 Nm

Material
Clamping plates CuNiSi

Legend
1) M10 / SW 17
2) Without hexagon nut and MS snap ring

Article-Nr.									
635.321.000	9	44	42					0.11	1

Technical Specifications: **Ground cable support EB**

Article No.	635.321.000
Length a	44 mm
Width b	42 mm
Catenary wire diameter	9 mm
Starting torque	25 N·m
comment	1
Commercial specification	
Customs number	85359000
country of origin	CH
Texte	
comment	1
Logistic specification	
Kilo / piece	0.11 kg

