

## Attaches à câble

### ■ SKTF5S Attache pour câble porteur et fil de contact

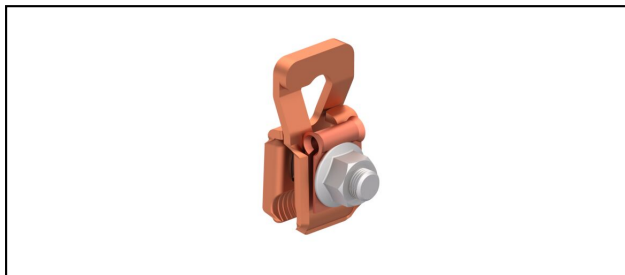

#### Application

Pour pendules à câble, équipotentiel





#### Description

Couple de serrage 20-25 Nm

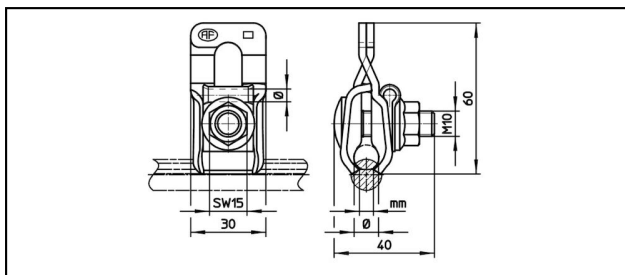
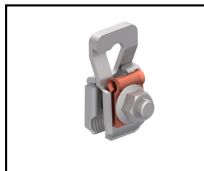
#### Matériel

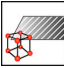
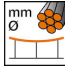
Corps en CuNiSi ou acier inoxydable

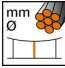
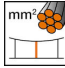
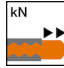

Réf. article									
620.001.000	InoxA2	9 - 13	50 - 95	5.5 - 7	4.5	10	4		0.109

Caractéristiques techniques: **Attache pour câble porteur et fil de contact SKTF5S**

Ref. article	620.001.000
<b>Matériel</b>	InoxA2
<b>Diamètre câble porteur</b>	9 - 13 mm
<b>Section câble porteurs</b>	50 - 95 mm <sup>2</sup>
<b>Rainure du fil de contact</b>	5.5 - 7 mm
<b>Diamètre fil de suspension</b>	4.5 mm
<b>Section fil de suspension</b>	10 mm <sup>2</sup>
<b>Force de glissade</b>	4 kN
	20 - 25 N·m
<b>Spécifications commerciales</b>	
<b>Numéro de tarif douanier</b>	85359000
<b>pays d'origine</b>	CH
<b>Spécifications logistiques</b>	
<b>Kilo / pièce</b>	0.109 kg