

Attaches à câble

■ SKTF5S

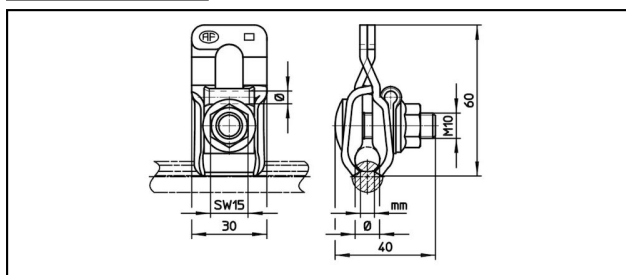

Application

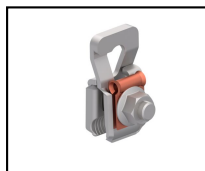
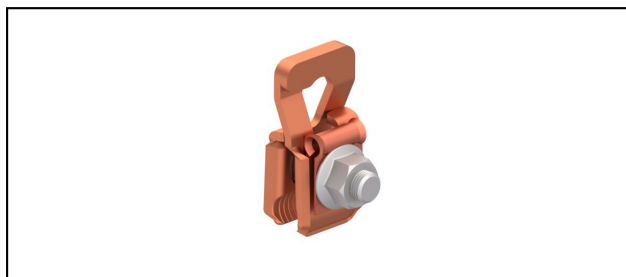





Pour pendules à câble, équipotentiel

Description

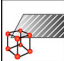
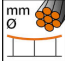
Couple de serrage 20-25 Nm

Matériel

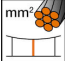
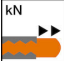
Corps en CuNiSi ou acier inoxydable

Réf. article									
625.035.000	CuNiSi	9 - 13	50 - 95	5.5 - 7	4.5	10	4		0.115
620.001.000	InoxA2	9 - 13	50 - 95	5.5 - 7	4.5	10	4		0.109

Caractéristiques techniques: **SKTF5S**

	625.035.000	620.001.000
Matériel	CuNiSi	InoxA2
Diamètre câble porteur	9 - 13 mm	
Section câble porteurs	50 - 95 mm ²	
Rainure du fil de contact	5.5 - 7 mm	
Diamètre fil de suspension	4.5 mm	
Section fil de suspension	10 mm ²	
Force de glissade	4 kN	
	20 - 25 N·m	
Spécifications commerciales		
Numéro de tarif douanier	85359000	
pays d'origine	CH	
Spécifications logistiques		
Kilo / pièce	0.115 kg	0.109 kg