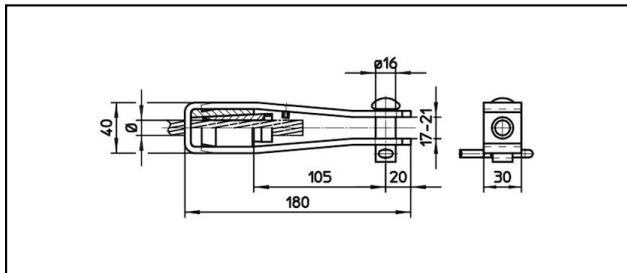

Morse di amarro

■ **GI40/30,B16** Morsa di amarro**Applicazione**

Conduttori Cu, Cu-acciaio o Bz sottoposti a tiro meccanico

Caratteristiche

Carico di esercizio min. 3 kN / max. 25 kN





Carico di rottura del corpo min. 60 kN

Materiale

Corpo acciaio inossidabile. Cono AIBz o in acciaio inossidabile.

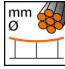
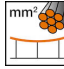
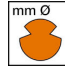
Legenda

- 1) Cono in acciaio inossidabile per cavi in inox
- 2) Con codice colore

Rif. Articolo									
610.031.176	S60 St	10.5	60					0.82	1

Specifiche tecniche: **Morsa di amarro GI40/30,B16**

Articolo no.	610.031.176
ferroviaria prodotto nome	S60 St
Diametro funi portanti	10.5 mm
Sezione funi portanti	60 mm ²
osservazione	1
Specifiche commerciali	
Numero di tariffa doganale	85359020
paese di origine	CH
Texte	
osservazione	1
Specificazione logistica	
Chilo / pezzo	0.82 kg

