

## Morse di amarro

### ■ GI40/40,B19 Spc. Morsa di amarro

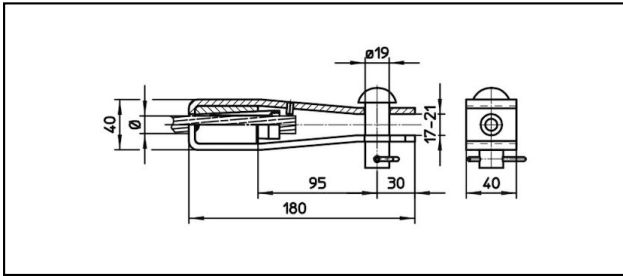

#### Applicazione

Conduttori Cu, Cu-acciaio o Bz sottoposti a tiro meccanico





#### Caratteristiche

Carico di esercizio min. 3 kN / max. 25 kN

Carico di rottura del corpo min.60 kN

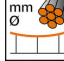
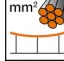
#### Materiale

Corpo in acciaio inossidabile. Cono in BzAl, bullone in acciaio zincato.

Rif. Articolo										
610.085.000	S70	10.8	70							0.91

Specifiche tecnici: **Morsa di amarro GI40/40,B19 Spc.**

Articolo no.	610.085.000
<b>ferroviaria prodotto nome</b>	S70
<b>Diametro funi portanti</b>	10.8 mm
<b>Sezione funi portanti</b>	70 mm <sup>2</sup>
Specifiche commerciali	
<b>Numero di tariffa doganale</b>	85359000
<b>paese di origine</b>	CH
Specificazione logistica	
<b>Chilo / pezzo</b>	0.91 kg