

Morse di amarro

■ **GI40/40,B20** Morsa di amarro**Applicazione**

Conduttori Cu, Cu-acciaio o Bz sottoposti a tiro meccanico

Caratteristiche

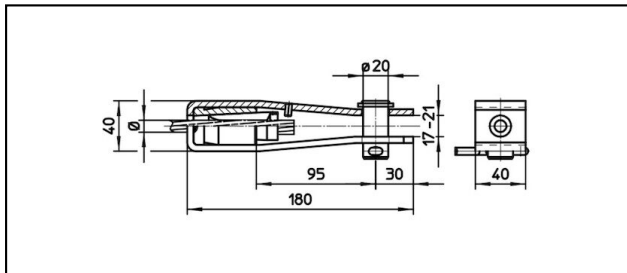



Carico di rottura del corpo min. 60 kN

Materiale

Corpo in acciaio inossidabile. Cono in BzAl.

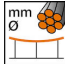
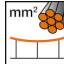
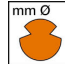
Legenda

1) Con codice colore

Rif. Articolo									
610.083.000	S70	10.8	70					0.9	1

Specifiche tecniche: **Morsa di amarro GI40/40,B20**

Articolo no.	610.083.000
ferroviaria prodotto nome	S70
Diametro funi portanti	10.8 mm
Sezione funi portanti	70 mm ²
osservazione	1
Specifiche commerciali	
Numero di tariffa doganale	85359000
paese di origine	CH
Texte	
osservazione	1
Specificazione logistica	
Chilo / pezzo	0.9 kg

