

Morse di amarro

■ **GI40/40,B20** Morsa di amarro**Applicazione**

Conduttori Cu, Cu-acciaio o Bz sottoposti a tiro meccanico

Caratteristiche

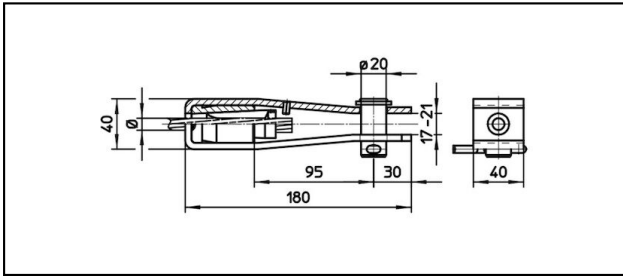



Carico di rottura del corpo min. 60 kN

Materiale

Corpo in acciaio inossidabile. Cono in BzAl.

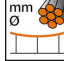
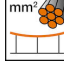
Legenda

1) Con codice colore

| Rif. Articolo |  |  |  |  |  | | |  |  |
|---------------|---|---|---|---|---|--|--|---|---|
| 610.080.001 | FD150 | | | 15 | 150 | | | 0.9 | 1 |

Specifiche tecniche: **Morsa di amarro GI40/40,B20**

| | |
|-----------------------------------|---------------------|
| Articolo no. | 610.080.001 |
| ferroviaria prodotto nome | FD150 |
| Diametro filo di contatto | 15 mm |
| Sezione filo di contatto | 150 mm ² |
| osservazione | 1 |
| Specifiche commerciali | |
| Numero di tariffa doganale | 85359000 |
| paese di origine | CH |
| Texte | |
| osservazione | 1 |
| Specificazione logistica | |
| Chilo / pezzo | 0.9 kg |

