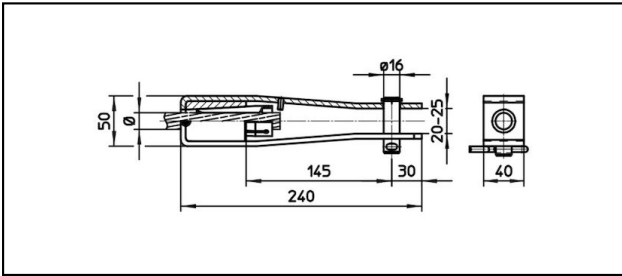

Morse di amarro

■ **G150/40,B16** Morsa di amarro**Applicazione**

Conduttori Cu, Cu-acciaio o Bz sottoposti a tiro meccanico

Caratteristiche

Carico di esercizio min. 3 kN / max. 25 kN







Carico di rottura del corpo min. 80 kN

Materiale

Corpo in acciaio inossidabile. Cono in BzAl o in acciaio inossidabile

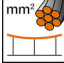
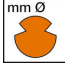
Legenda

- 1) Cono in acciaio inossidabile per cavi in inox
- 2) Corpo in acciaio inossidabile A4

Rif. Articolo									
610.090.000	S120							1.51	

Specifiche tecnici: **Morsa di amarro GI50/40,B16**

Articolo no.	610.090.000
ferroviaria prodotto nome	S120
Specifiche commerciali	
Numero di tariffa doganale	85359000
paese di origine	CH
Specificazione logistica	
Chilo / pezzo	1.51 kg

