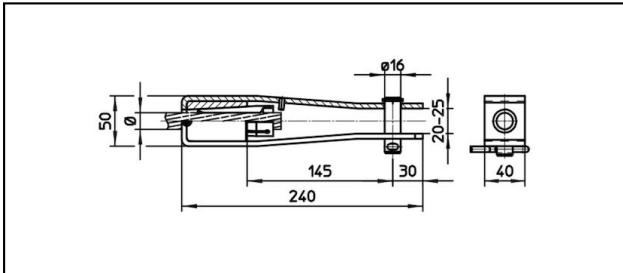

Morse di amarro

■ **G150/40,B16** Morsa di amarro**Applicazione**

Conduttori Cu, Cu-acciaio o Bz sottoposti a tiro meccanico

Caratteristiche

Carico di esercizio min. 3 kN / max. 25 kN







Carico di rottura del corpo min. 80 kN

Materiale

Corpo in acciaio inossidabile. Cono in BzAl o in acciaio inossidabile

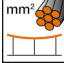
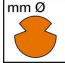
Legenda

- 1) Cono in acciaio inossidabile per cavi in inox
- 2) Corpo in acciaio inossidabile A4

Rif. Articolo									
610.026.111	S185	17.5	185					1.51	

Specifiche tecnici: **Morsa di amarro GI50/40,B16**

Articolo no.	610.026.111
ferroviaria prodotto nome	S185
Diametro funi portanti	17.5 mm
Sezione funi portanti	185 mm ²
Specifiche commerciali	
Numero di tariffa doganale	85359000
paese di origine	CH
Specificazione logistica	
Chilo / pezzo	1.51 kg