

Morsetti

■ SKT2 Morsetto per fune portante

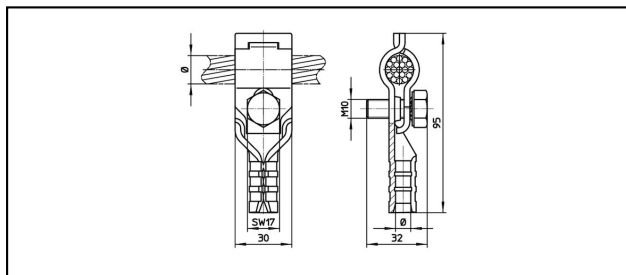
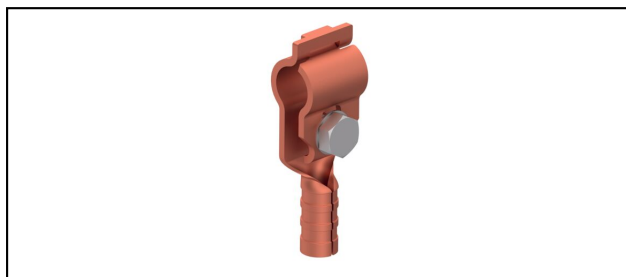

Applicazione

Per pendini equipotenziali

Caratteristiche





Coppia di serraggio 12 Nm

1) KZ 13 (3x)

KZ = Numero indicativo per la pressa, matrice per triplo serraggio disponibile

Materiale

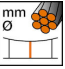
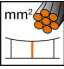
Corpo in E-Cu

| Rif. Articolo |  |  |  |  | | | | |  |
|---------------|---|---|---|---|--|--|--|--|---|
| 625.039.000 | 15 - 18 | 150 - 185 | 4.5 | 10 | | | | | 0.14 |

Specifiche tecnici: **Morsetto per fune portante SKT2**

| | |
|---|---------------------------|
| Articolo no. | 625.039.000 |
| Coppia di serraggio | 12 N·m |
| Diametro funi portanti | 15 - 18 mm |
| Sezione funi portanti | 150 - 185 mm ² |
| Diametro del filo di sospensione | 4.5 mm |
| Sezione del filo di sospensione | 10 mm ² |
| Specifiche commerciali | |
| Numero di tariffa doganale | 85359000 |
| paese di origine | CH |
| Specificazione logistica | |
| Chilo / pezzo | 0.14 kg |

