

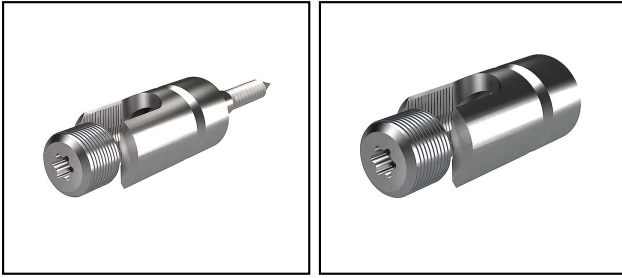

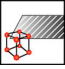
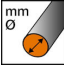

Componenti di fissaggio

■ **AV 20** Supporto per conduttore**Legenda**

a) Distanza dalla parete: 30mm

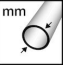
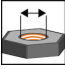
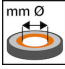
Rif. Articolo	Numéro-E									
245.031.305	156 811 200	CuvNi	6 - 8		14	M6				20

Specifiche tecniche: **Supporto per conduttore AV 20**

Articolo no.	245.031.305
Materiale	CuVNi
Diametro del filo	6 - 8 mm
Diametro esterno	14 mm
Filettatura interna	M6
Distanza parete	10 mm
Tipo di fissaggio conduttore	con fascetta a vite
Tipo di fissaggio supporto	foro con filettatura M
Materiale del supporto	rame
Specifiche commerciali	
Numero di tariffa doganale	85389000
paese di origine	CH
Specificazione logistica	
VPE Peso	0.505 kg

